

show light 12v Halogen

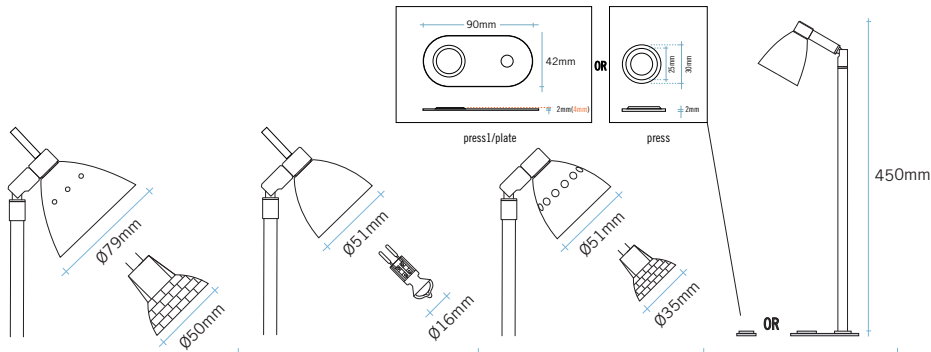

AL-07/Y
Ø50mm dichroic or reflector
halogen lamp:
20W
35W
50W

AL-07/M1
Ø16mm front axial reflector
halogen lamp:
20W
35W
50W

AL-07/M2
Ø35mm dichroic or reflector
halogen lamp:
20W
35W

AL-07/Press/Plate
AL-07/Press



AL-07- Detail

SHOW/AL-07 Design: Aktiva, 1988 Manufacture: Aktiva, London.

Fully adjustable 90° tilt and 360° rotation stem light.
Very effective light source for desk and display
lighting applications.

LAMPS

12v Ø 50mm 50W, 35W, 20W dichroic or reflector halogen
12v Ø 35mm 35W, 20W dichroic or reflector halogen
12v Ø 16mm 50W, 35W, 20W front axial reflector halogen

OPTIONS

/ clip	exhibition clip fixings
/ control	control arm
/ e	fixing to permit any length of stem
/ emergency	3 hour maintained
/ ex	exhibition stand panel mount with integral transformer
/ f	flush fixing
/ g60	surface mounted integral transformer
/ j	jack socket fixing
/ m1	lamp shade option for Ø 16mm front axial reflector halogen
/ m2	lamp shade option for Ø 35mm dichroic or reflector halogen
/ 0	allthread fixing
/ p	standard stem length - 100mm, 200mm, 300mm, 500mm
/ s	surface box
/press1	remote on/off touch switch
/press2	remote dimming touch and on/off switch
/press1/plate	integral on/off touch switch
/press2/plate	integral dimming touch and on/off switch
/ w	washer fixing
/ y	Ø 75mm for 50mm halogen lamp

FINISHES

standard coated: white, silver
standard plated: polished chrome, satin chrome
other finishes may be requested



AL-07/Display/Y/W2/300mm



AL-07/control/W2/200mm

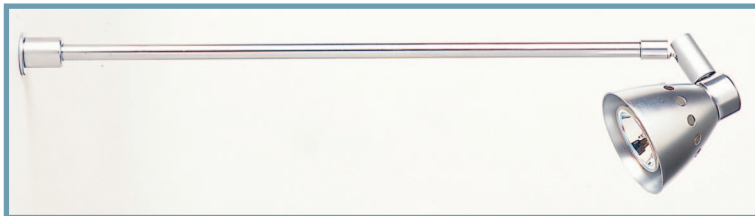

AL-07/Display/M2/W1/E1/300mm



AL-07/Desk/M2/Contro/Press/Plate



The Carephone Warehouse /
United Designers

AL-07/W2/300mm/
Polished Chrome

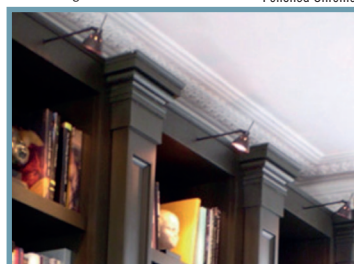

Residential/John Minshaw Designs

AL-07/Book