

Lighting Diagram
Primary Healthcare Trust Reception

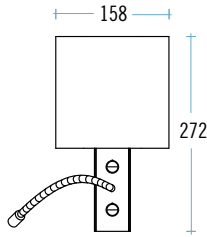

Bedside LED & Shaded Fluorescent

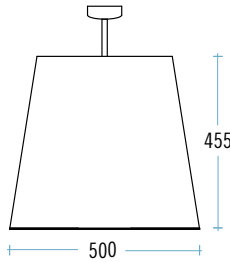

Accessorize Shade

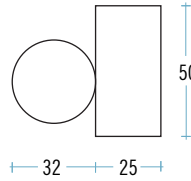

B-Line/Mirror



Primary Healthcare Trust Reception
Community Solutions

Looklight

SPECIAL PROJECTS

Design: Aktiva

Aktiva works with specifiers on projects requiring special light fittings, lighting schemes or adaptations of lights in the current range. Here are some recent examples.

LIGHTING SCHEMES

Project: Primary Healthcare Trust Reception
Client: Community Solutions
Architect: Capita Percy Thomas
Fitting: B-Line Desk
Square One
Looklight

Aktiva recommended a lighting scheme and the lights for a 200m² reception. Scheme is a template for the client's future primary healthcare reception projects.



Primary Healthcare Trust Reception
Community Solutions

Square One Pendant



Sopwell House Hotel, Herts
AB Hotels

Bedside LED & Shaded Fluorescent

HOTEL LIGHTING

Project: Sopwell House Hotel, Herts
Client: AB Hotels
Fitting: Bedside LED & Shaded Fluorescent

Aktiva briefed to design contemporary but value-engineered fitting for bedside. Designed and supplied in 6 weeks.

SPECIAL SHADES

Project: Accessorize Lights
Client: Monsoon Accessorize
Interior Designer: JHP
Fitting: Large Shaded Feature Lighting

Client required special shaded fittings with bespoke design for a worldwide rollout. Aktiva can make shades with designs to virtually any size.

DRAGONFLY APARTMENTS

Project: Dragonfly Apartments, Bermondsey, London
Client: Wharf Developments
Interior Designer: Idom UK
Fitting: B-Line/Mirror

Quality in the detail of a project is a driver for Wharf Developments. Aktiva has designed a bathroom mirror light based on its highly versatile b-line range of linear fluorescents for this 40-apartment scheme.



Dragonfly Apartments, Bermondsey, London
Wharf Developments

B-Line/Mirror



Accessorize Lights
Monsoon Accessorize

Large Shaded Feature Lighting